

Expand MediaScreen 2 Set-up Instruction

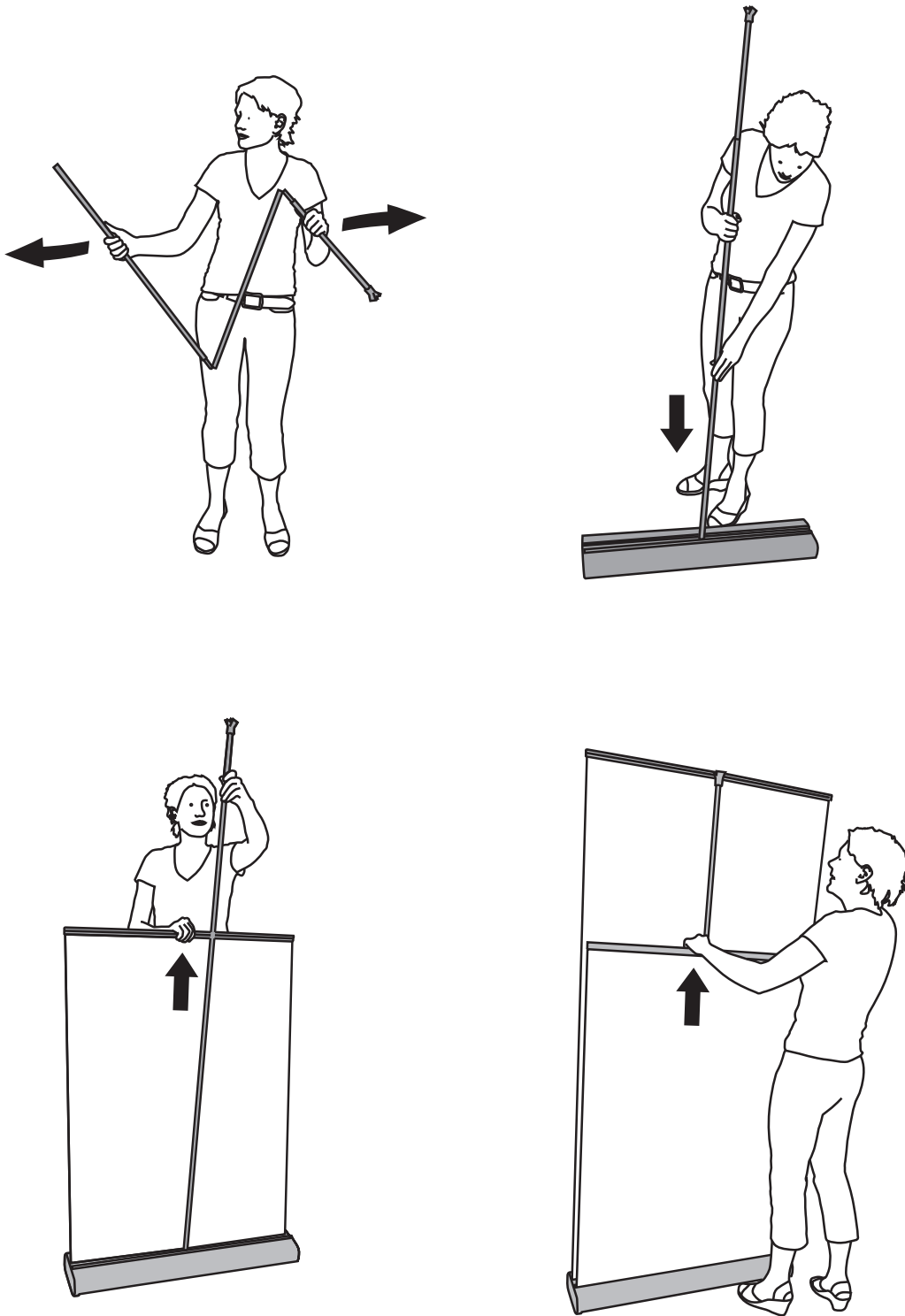

Graphic Installation Expand MediaScreen 2

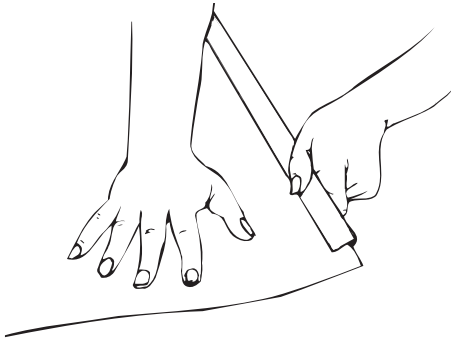

1. Slide the profile on to the graphic

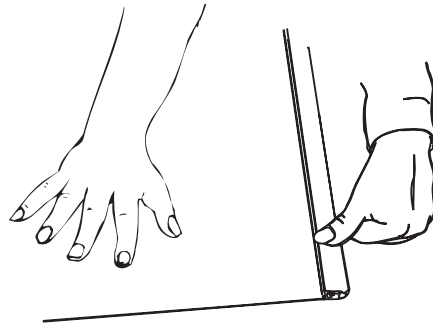

2. Snap on

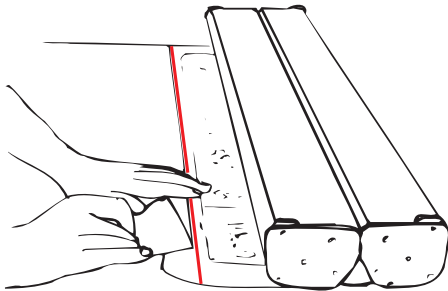

3. Remove the protective strip.
Apply the graphic with picture side upwards
and position along the red line.

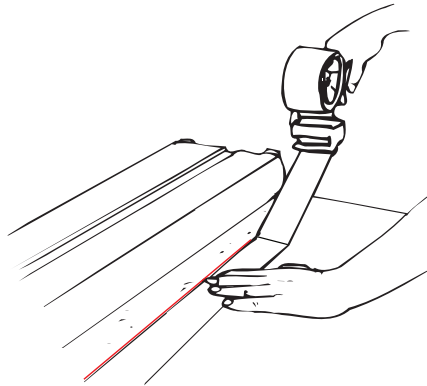

5. Apply packing tape over the joint!

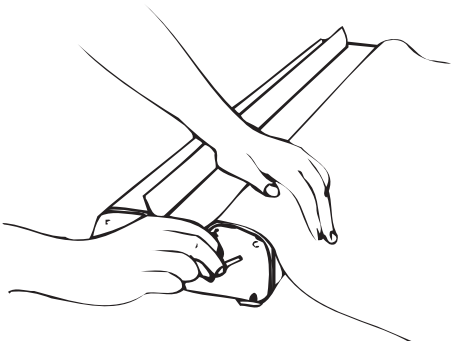

6. Grip the graphic and the base with
your left hand. Remove the locking pin
with your right hand. The mechanism is
now activated!

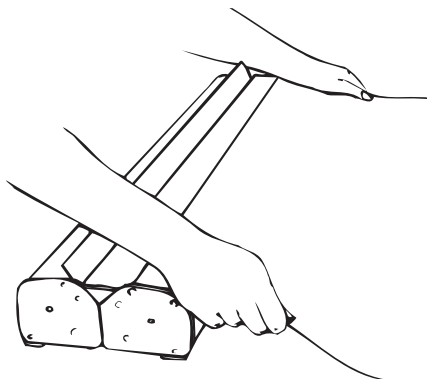

7. Slowly and carefully allow the graphic to retract
into the unit.
8. Repeat these steps for applying the second graphic