

Lock & Roll Banner Installation and Removal

Warning: Do not move the switch on the right side of the base to Unlock prior to installing a banner.

To install a banner:

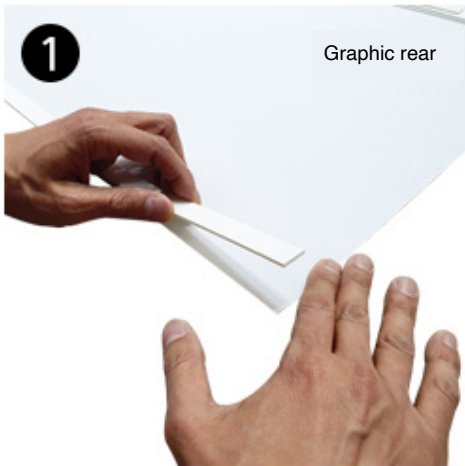

Attach panel strip to top rear and bottom rear of the graphic.



Secure panel strip with a stapler, then hammer down the sharp ends of the staples.

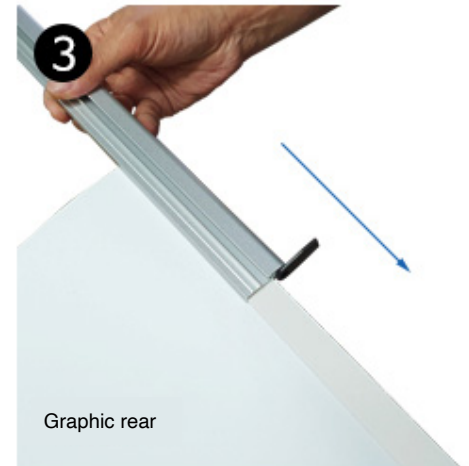

Fold over the graphic 1x (if the material allows) for extra hold. Insert the top panel strip and slide top rail onto the graphic.

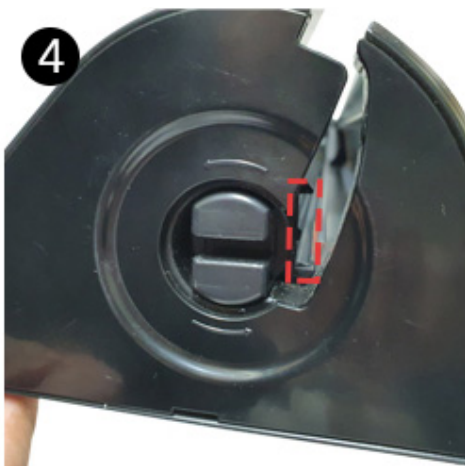

Align the bottom panel strip with the groove in the opening of the left side of the base.



Insert the panel strip and slide it into the groove.



Before unlocking, be sure to hold down the graphic. A sudden retraction of the graphic can result in damage.

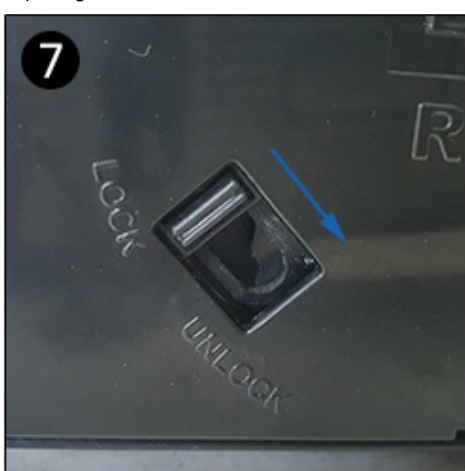

Move the switch to unlock while still keeping a hand firmly on the graphic.



Guide the graphic, helping it to stay centered, as it retracts into the base.

Lock & Roll Banner Installation and Removal

To remove a banner:

1



Hook the top rail to the clip on the support pole and raise the pole to its maximum height, taking care not to overextend it, which can cause damage.

2



Move the switch on the right side of the base to the Lock position.

3



Loosen each section of the support pole.

4



Unhook the top rail and carefully lay the banner down.

5

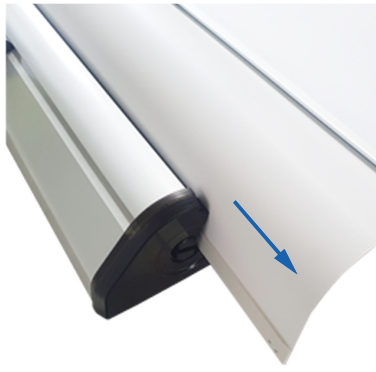

Check that the groove lines up with the opening of the left side of the base and slide the graphic out. If that opening doesn't line up: hold down the graphic, move the switch to Unlock, and pull the graphic out until the groove lines up with the opening. Then, move the switch back to Lock.

To add tension to the roller:

1



Move the switch on the right side of the base to the Lock position.

2



Use a quarter to turn the knob on the left side of the base about 20 full revolutions, using the groove as a guide.