

SET UP INSTRUCTION

3 - Parted Pole

- 1 Remove the base unit and the 3 part pole from the carry bag, then unfold the pole to assemble it.

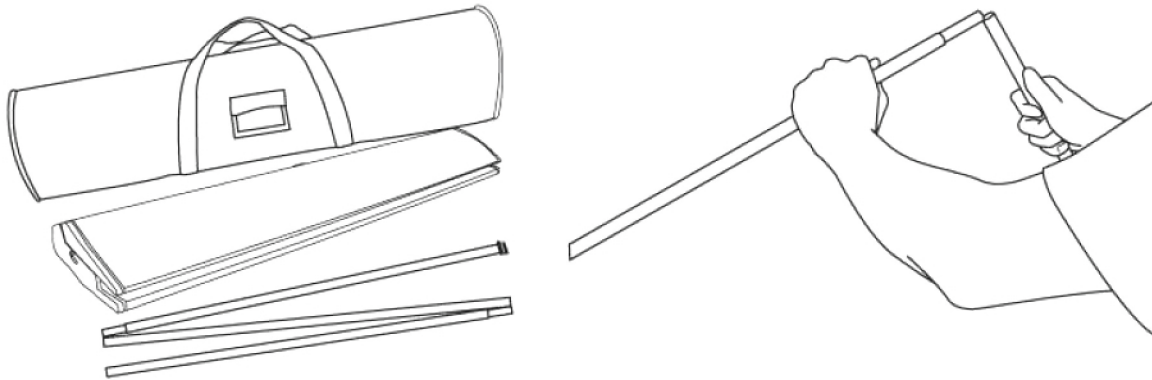

- 2 Position the pole in the plastic location point in the centre of the base. Gently pull the graphic upwards out of the base by holding the aluminium rail. Securely locate the rail over the plastic moulding at the top of the pole.

