

Expand QuickScreen 3 Graphic Panel Mounting Instruction

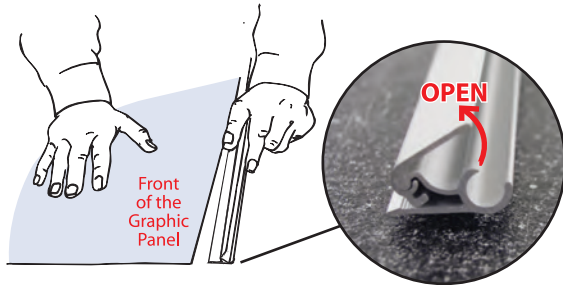

Step 1: Using a tool such as a flat blade screw driver, open the snap profile and insert the image.

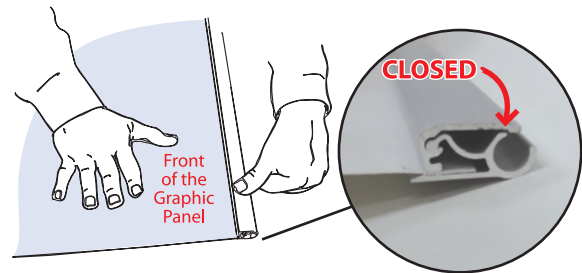

Step 2: Press down and secure the image in the snap profile. Start by pressing down on the outside and working in towards the middle.



Step 3: Turn the Expand QuickScreen 3 upside down. Undo the thumb screws.

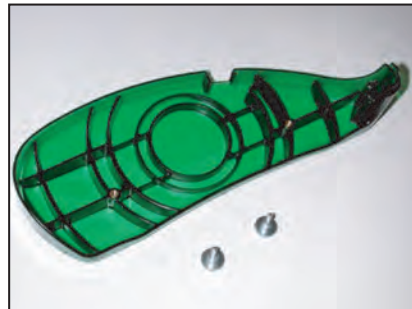

Step 4: Remove the plastic end cap to expose the pin that holds the tension on the display (indicated by the red arrow). **DO NOT REMOVE THE PIN AT THIS POINT**

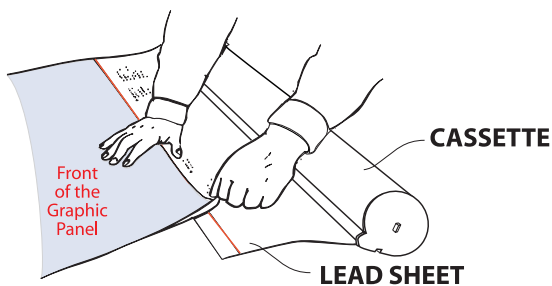
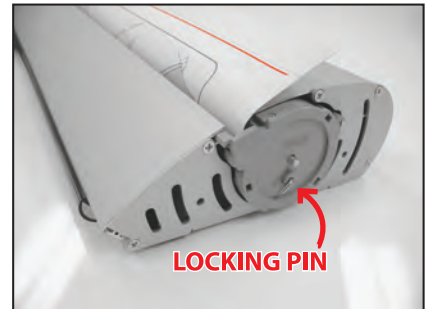

Step 5: Remove the protective film. Apply the image with picture side upwards and position along the red line.

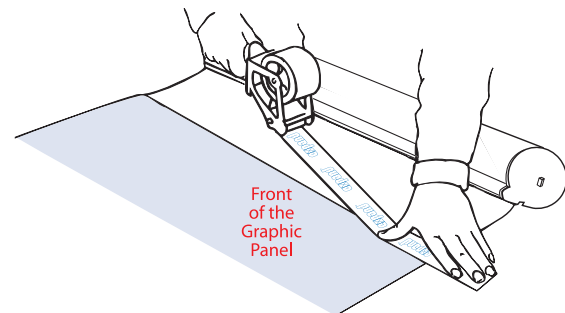

Step 6: IMPORTANT! Apply a packing tape (like the white Expand Logo tape) over the joint.

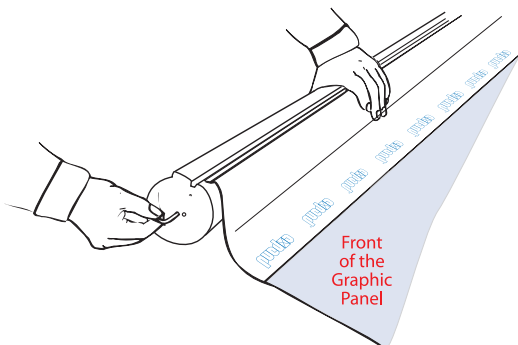

Step 7: Grip the image and cassette with the left hand. Remove the locking pin with the right hand.
THE MECHANISM IS NOW ACTIVATED

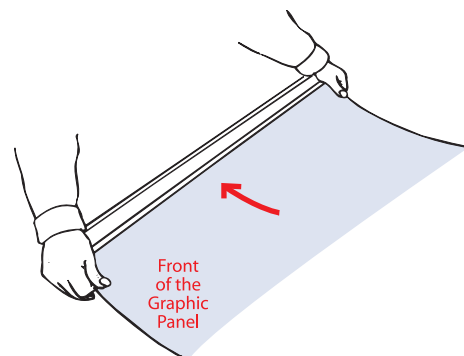

Step 8: With your hands, slowly allow the graphic panel to retract into the base.